



*Trailer Maintenance*

## **DUMP WAGONS**

Patterson Equipment  
903 Concession 12  
Waterford  
Ontario  
N0E1Y0

519-718-9404  
[pattersonequipment@hotmail.com](mailto:pattersonequipment@hotmail.com)  
[www.pattersonequipment.ca](http://www.pattersonequipment.ca)

07/2025



**THESE INSTRUCTIONS MUST BE  
READ BEFORE OPERATING THE  
TRAILER**

**THIS MANUAL MUST ALWAYS  
REMAIN WITH THE TRAILER**

**GENERAL SAFETY AND ACCIDENT  
PREVENTATION**

**Esure attention is paid to all  
warning/information stickers provided in  
various areas of your trailer - these ensure  
your safety. ALWAYS make sure  
warning/information stickers are kept clear  
and in good condition.**

## **MAINTENANCE AND SERVICE SCHEDULE**

*Warranty will be void if the maintenance schedule is not followed.*

<b>Daily</b>
Check operation of all lights
Visually check wheel nuts are tight. If any appear loose torque <b>ALL</b> wheel nuts.
Check tyre pressures and the condition of the tyres
Grease body tipping pivots
Grease tail door cylinders
Grease tail door pivots
Grease sprung drawbar
Grease towing eye
Check condition of towing eye
Grease walking bogie pivot points
Grease tipping cylinder pivots. Top and bottom
Check operation of brakes
Check all safety decals are clean and visible
<b>Weekly</b>
Check bolt on hitch bolts
Check wheel nut torque
Grease brake cams
Inspect the trailer for loose nuts and bolts
<b>Every 3 months</b>
Check brake clearance and wear
Check brake/slack adjuster setting
Check sprung drawbar springs
<b>Every year</b>
Check the axle bearings for movement and wear
<b>Every 2 years</b>
Lubricate wheel bearings

### Towing eye

Weekly check condition of the towing eye for wear. Towing eye must be replaced if it exceeds the following dimensions.

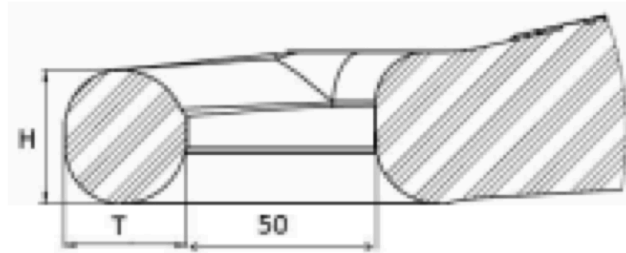

Description	Nominal Dimension	Wear Dimension
Eye diameter (A)	50.4 mm	52.5 mm
Ring Height (H)	40.0 mm	33.5 mm
Web Front Width (T)	32.5 mm	28.5 mm

### Wheel nut torque

**Torque wheel nuts upon delivery  
and after the first day of use.**



10-Stud Wheel



8-Stud Wheel



6-Stud Wheel

No. of studs	Torque (Nm)
6	300
8	400
10	600